

Getting Around Adventist Medical Center

10123 SE Market St.
Portland, Oregon 97216
(503) 257-2500 (360) 699-4488
(503) 261-6610 TTY-Hearing Impaired Assistance

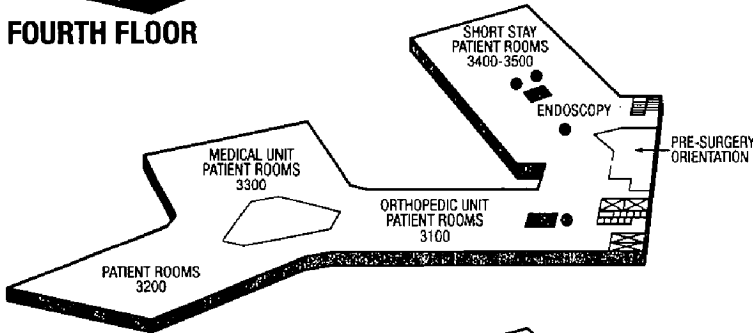

- ELEVATOR
- STAIRS
- RESTROOM
- PHONE

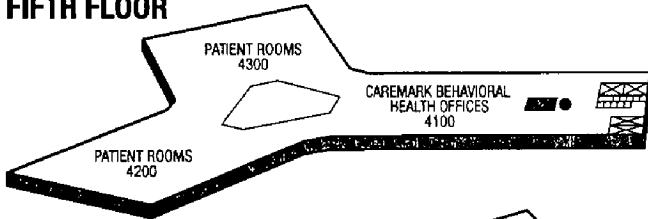
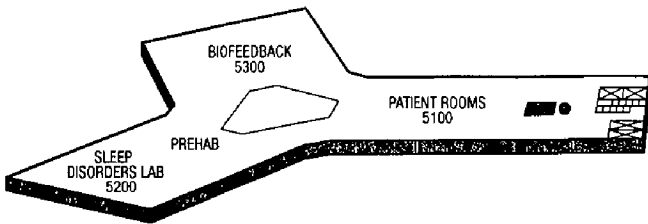
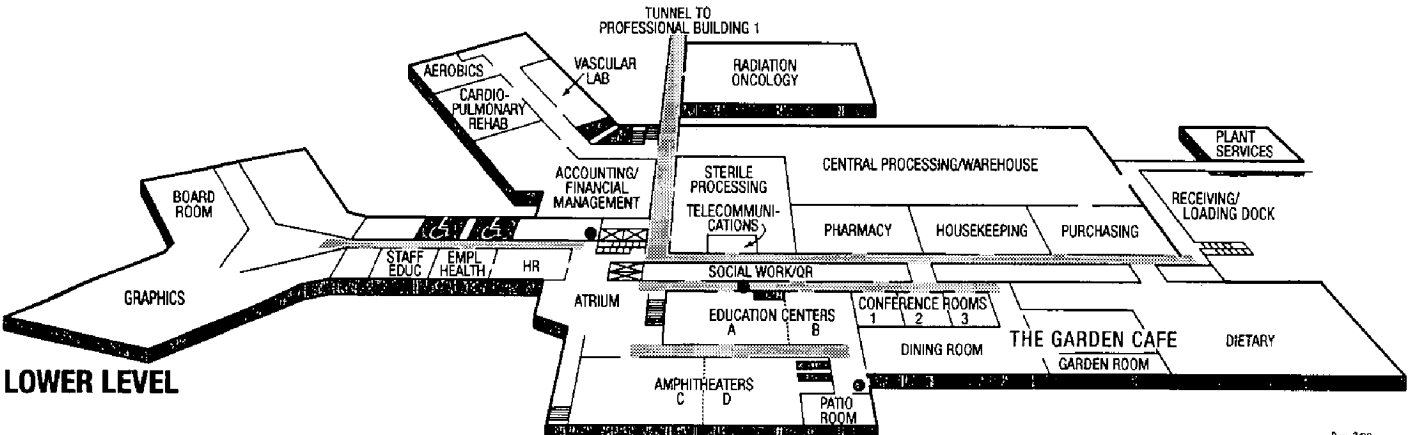
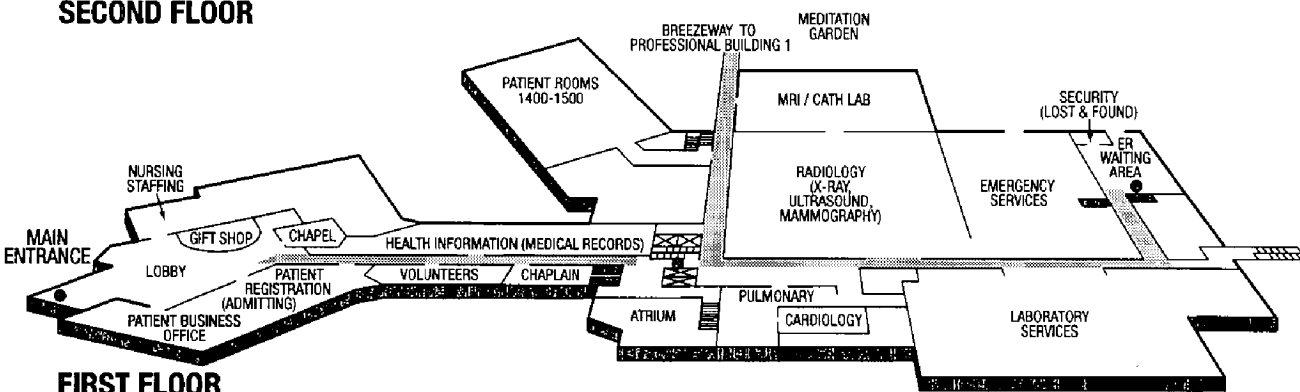
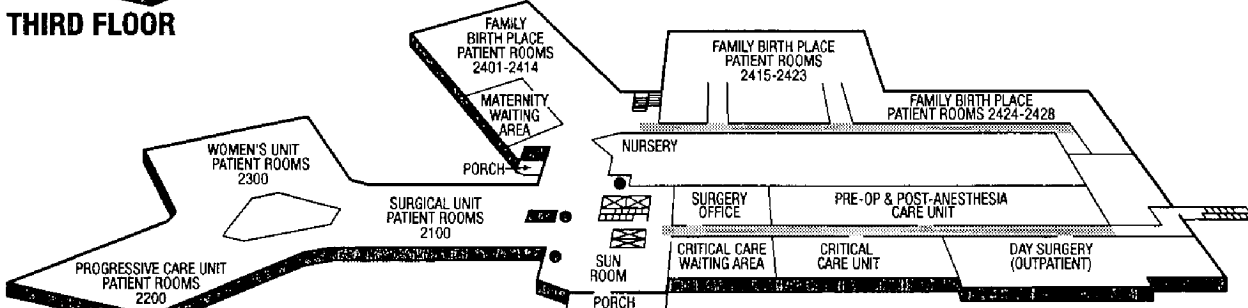
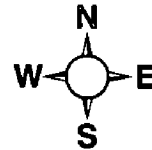

Getting to Adventist Medical Center

FROM I-84

Take the I-205 south exit (Salem). Stay in the right lane and watch for the immediate Glisan/Stark exit. Take the exit. Follow the green road signs directing toward Mall 205. This will take you across Glisan and Stark, left onto Washington, and right onto 99th. (The blue "H" signs will also help direct you.) Stay on 99th past Mall 205 and follow the signs to the hospital.

FROM I-205

Take the Glisan/Stark exit (if traveling southbound) or the Stark/Washington exit (if traveling northbound). Follow the green "Mall 205" and blue "H" road signs directing you onto Washington and then right onto 99th. Stay on 99th past Mall 205 and follow the signs to the hospital.

FROM DIVISION

Turn north onto 96th Avenue. Proceed on 96th to the four-way stop on Market. Turn right onto Market; follow signs to hospital.

FROM STARK/WASHINGTON

Turn south onto 99th Avenue. Stay on 99th past Mall 205 and follow signs to the hospital.

BY BUS AND/OR LIGHT RAIL

The hospital is served directly by Tri-Met buses #15 and #27 (Market-Main), which connects with the Gateway Transit Center. For more information, call Tri-Met at 238-RIDE (7433).

