



CITY OF  
**PORTLAND, OREGON**



BUREAU OF POLICE

**Tammie V. Milkes**

Community Relations Assistant  
Planning & Support Division

1111 S.W. 2nd Ave  
Room 1552

Phone: (503) 823-0259

FAX: (503) 823-0289

Portland, Oregon 97204 e-mail: [tmilkes@police.ci.portland.or.us](mailto:tmilkes@police.ci.portland.or.us)

## Crisis Intervention Team Training Evaluation:

*Class Date:* \_\_\_\_\_

*Class Title:* \_\_\_\_\_

*Instructor:* \_\_\_\_\_

Please Circle One Response:

	<u>Excellent</u>	<u>Above Average</u>	<u>Average</u>	<u>Fair</u>	<u>Poor</u>
Class Content:	5	4	3	2	1
Organization of Material:	5	4	3	2	1
Presentation of Material:	5	4	3	2	1
Instructor Knowledge of Subject:	5	4	3	2	1
Overall Presentation:	5	4	3	2	1

What portion of the material, if any, did you find to be most informative and beneficial?

List any changes that you would recommend to make this course more informative, beneficial, or would improve overall presentation.

Other comments?

# Getting Around Adventist Medical Center

10123 SE Market St.  
Portland, Oregon 97216  
(503) 257-2500 (360) 699-4488  
(503) 261-6610 TTY-Hearing Impaired Assistance

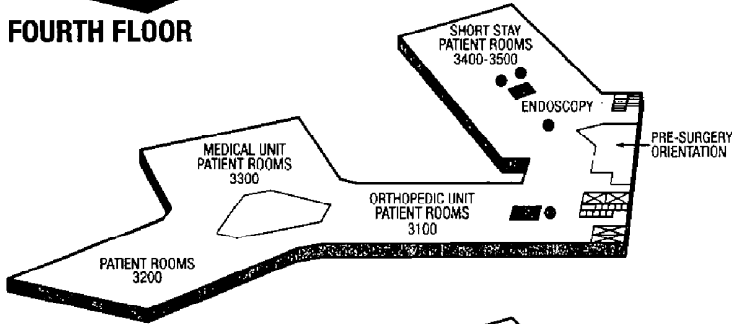
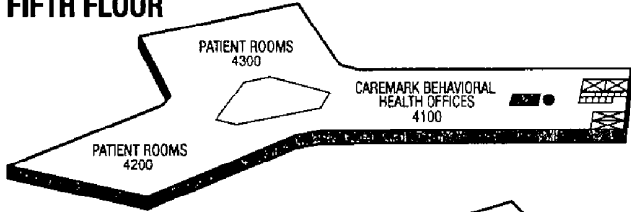
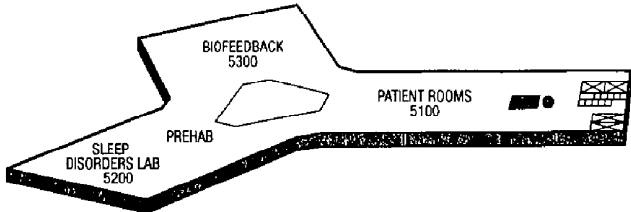

- ELEVATOR
- STAIRS
- RESTROOM
- PHONE

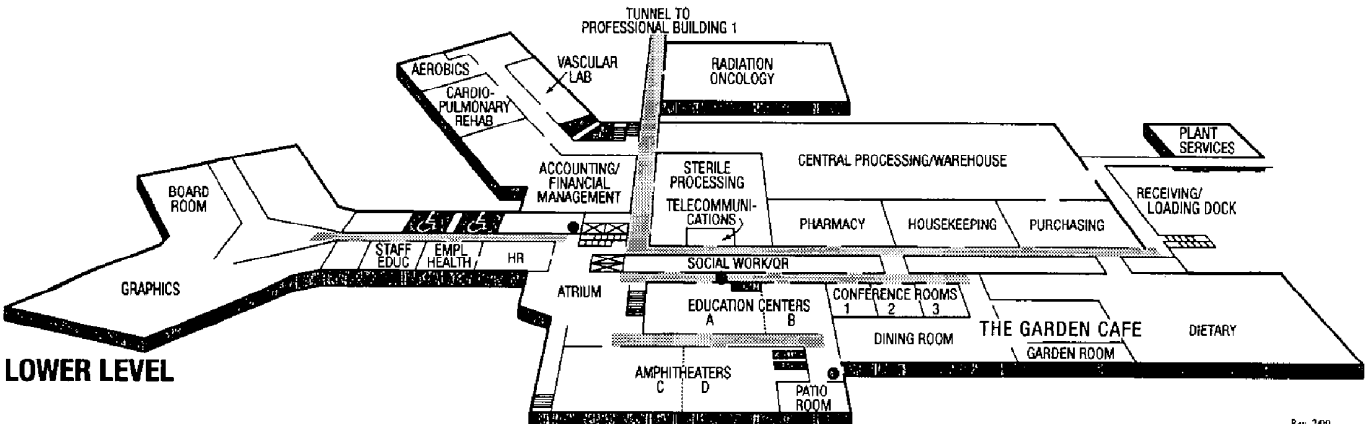
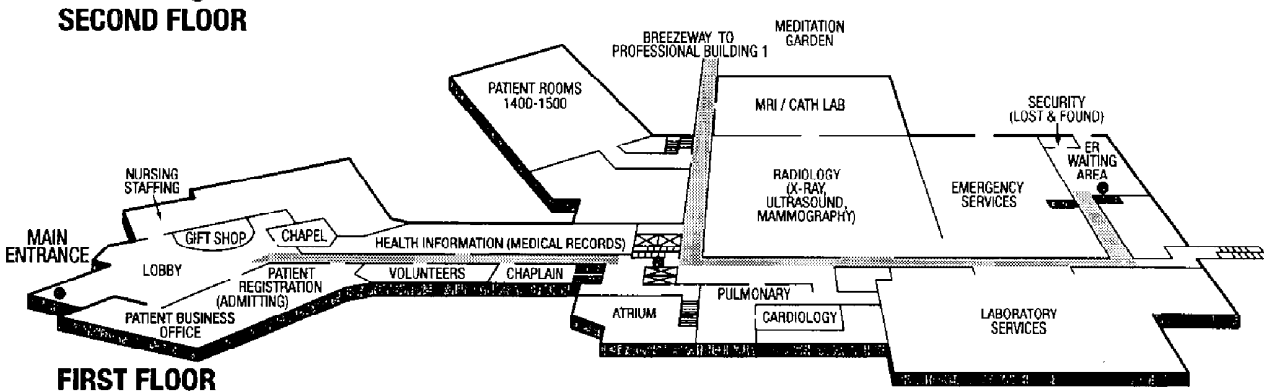
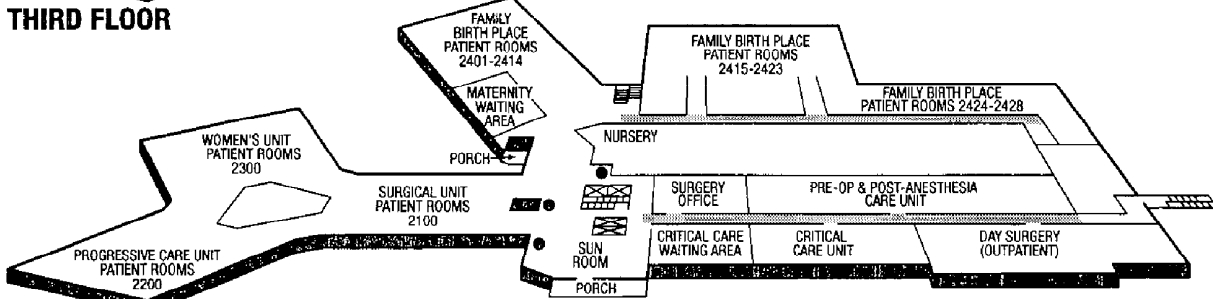
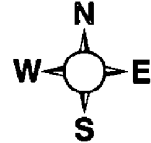

## Getting to Adventist Medical Center

### FROM I-84

Take the I-205 south exit (Salem). Stay in the right lane and watch for the immediate Glisan/Stark exit. Take the exit. Follow the green road signs directing toward Mall 205. This will take you across Glisan and Stark, left onto Washington, and right onto 99th. (The blue "H" signs will also help direct you.) Stay on 99th past Mall 205 and follow the signs to the hospital.

### FROM I-205

Take the Glisan/Stark exit (if traveling southbound) or the Stark/Washington exit (if traveling northbound). Follow the green "Mall 205" and blue "H" road signs directing you onto Washington and then right onto 99th. Stay on 99th past Mall 205 and follow the signs to the hospital.

### FROM DIVISION

Turn north onto 96th Avenue. Proceed on 96th to the four-way stop on Market. Turn right onto Market; follow signs to hospital.

### FROM STARK/WASHINGTON

Turn south onto 99th Avenue. Stay on 99th past Mall 205 and follow signs to the hospital.

### BY BUS AND/OR LIGHT RAIL

The hospital is served directly by Tri-Met buses #15 and #27 (Market-Main), which connects with the Gateway Transit Center. For more information, call Tri-Met at 238-RIDE (7433).

